

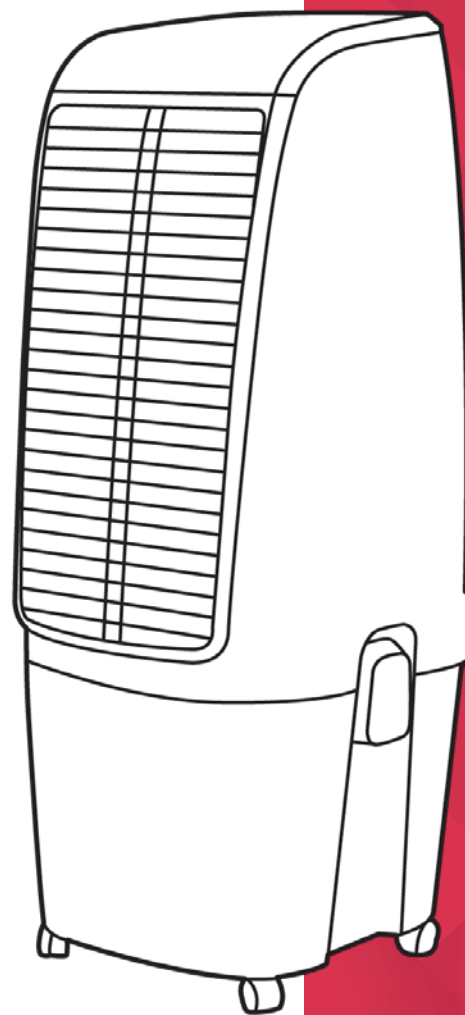

INSTRUCTION MANUAL



20L Evaporative Cooler

Model: DCEVP20W

For domestic household use
only.



IMPORTANT

THESE INSTRUCTIONS SHOULD BE READ CAREFULLY AND RETAINED FOR FUTURE REFERENCE. **Note also the information presented on the appliance**

CAUTION: FAILURE TO FOLLOW THESE INSTRUCTIONS MAY CAUSE INJURY AND/OR DAMAGE AND MAY INVALIDATE YOUR WARRANTY

Please read the operating instructions carefully before using your evaporative cooler for the first time and keep them in a safe place.

WARNING - This appliance must not be used in a bathroom.

WARNING - Do not use this appliance in the immediate surroundings of a bath, a shower or a swimming pool.

- Never immerse the appliance in water or other liquids.
- Operate this unit only on a firm, flat surface to avoid the risk of water leakage. Ensure that the unit is kept upright at all times.
- Do not place on soft, unstable or non-horizontal/angled surfaces.
- Never operate the appliance if a cable or connector has been damaged, after appliance malfunction or if the appliance was dropped or is otherwise damaged.
- If the mains lead is damaged it must only be replaced by the manufacturers service agent or a similarly qualified person in order to avoid a hazard.
- Please ask a professional service agent to repair the product. Improper repair may cause danger to users.
- Disconnect the appliance from mains power whenever it is not in use, before relocating it, and before cleaning.
- Operate the appliance only at the voltage specified on the rating label.
- Only connect the unit to a properly installed and easily accessible socket so that you can quickly disconnect the plug if necessary.
- Do not connect this product to the mains using an extension lead.
- This evaporative cooler is only intended for **INDOOR RESIDENTIAL** applications. This evaporative cooler should not be used for commercial or industrial or leisure applications or in small enclosed spaces.
- Never use the mains lead as a carrying strap or pulling lead.
- To avoid a fire or electrocution hazard, **NEVER** put the cord near heat registers, radiator, stoves or heaters.
- **DO NOT** cover cord with carpeting, throw rugs, runners, or similar coverings.
- **DO NOT** route cord under furniture or appliances. Take care to position the cord away from traffic areas and where it will not be a tripping hazard.
- **DO NOT** use the unit near windows or where water collects. Rain and water collection may lead to a risk of fire or electric shock.
- Only operate this appliance with a minimum of 50cm clearance all around i.e. away from walls, furniture and overhanging objects such as curtains or a shelf.

- This appliance is not intended for use by persons (including children) with reduced physical, sensory or mental capabilities, or lack of experience and knowledge, unless they have been given supervision or instruction concerning use of the appliance by a person responsible for their safety.
- Children should be supervised to ensure they do not play with the appliance.
- To prevent spillage, empty the water tank before lifting or relocating the appliance.
- **WARNING:** To avoid danger of suffocation please remove all packaging materials particularly plastic and EPS and keep these away from vulnerable people, children and babies.
- **NEVER** drop or insert any object or fingers into any openings.
- Do not use the appliance in locations where paint, petrol or other flammable liquids are used or stored.
- If the supply cord is damaged, it must be replaced by the manufacturer, its service agent or similarly qualified persons in order to avoid a hazard.
- Do not use bug sprays or other flammable cleansers/vapour sprays on or around the unit.
- Always switch off the unit and take the plug out of the socket:
 - If you are not using the unit
 - Before you clean or carry out maintenance on the unit
 - If a fault occurs
 - In the event of an electrical storm.
- Avoid electromagnetic interference. Keep the unit at least 1 metre away from electrical appliances such as televisions & radios.
- **DO NOT** use this appliance with an extension lead or power cord.

WARNING - KEEP BATTERIES OUT OF REACH OF CHILDREN

- Swallowing may lead to serious injury in as little as 2 hours or death, due to chemical burns and potential perforation of the oesophagus.
- If you suspect your child has swallowed or inserted a button battery immediately call the 24-hour Poisons Information Centre on 13 11 26 (in Australia) or 0800 764 766 (in New Zealand) for fast, expert advice.
- Examine devices and make sure the battery compartment is correctly secured, e.g. that the screw or other mechanical fastener is tightened. Do not use if the compartment is not secure.
- Dispose of used button batteries immediately and safely. Flat batteries can still be dangerous.





Exposed to the weather outdoors



Near water



If the power cable wires are frayed or cut



Where small children may be left unattended

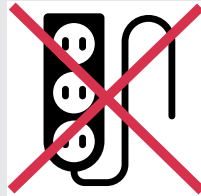

No extension leads or power cords



Where the power cable may be damaged



On a slope or uneven surface



Where there is risk of fire or close to a naked flame



Where it may be damaged by chemicals



Where there is a risk of interference by foreign objects



This product is not made for DIY repair



If there is a risk of water falling on the unit

Specification

Model no.	DCEVP20W
Colour	White/Black
Power supply	220-240V~, 50Hz
Rated power	110W
Speed settings	4
Modes	3 (natural, normal & sleep)
Turbo air speed	9m/s
Water tank capacity	20L
Remote control	Y
Timer	0-8 hours
Swing function	Y
Controls	Touch with LED display
Max. room size	40m ²
Water consumption	2L/h (high speed)
Weight (net)	8kg
Dimensions (w x d x h)	342 x 390 x 897mm

- For greater precision, please always refer to the rating label placed on the product.

Parts

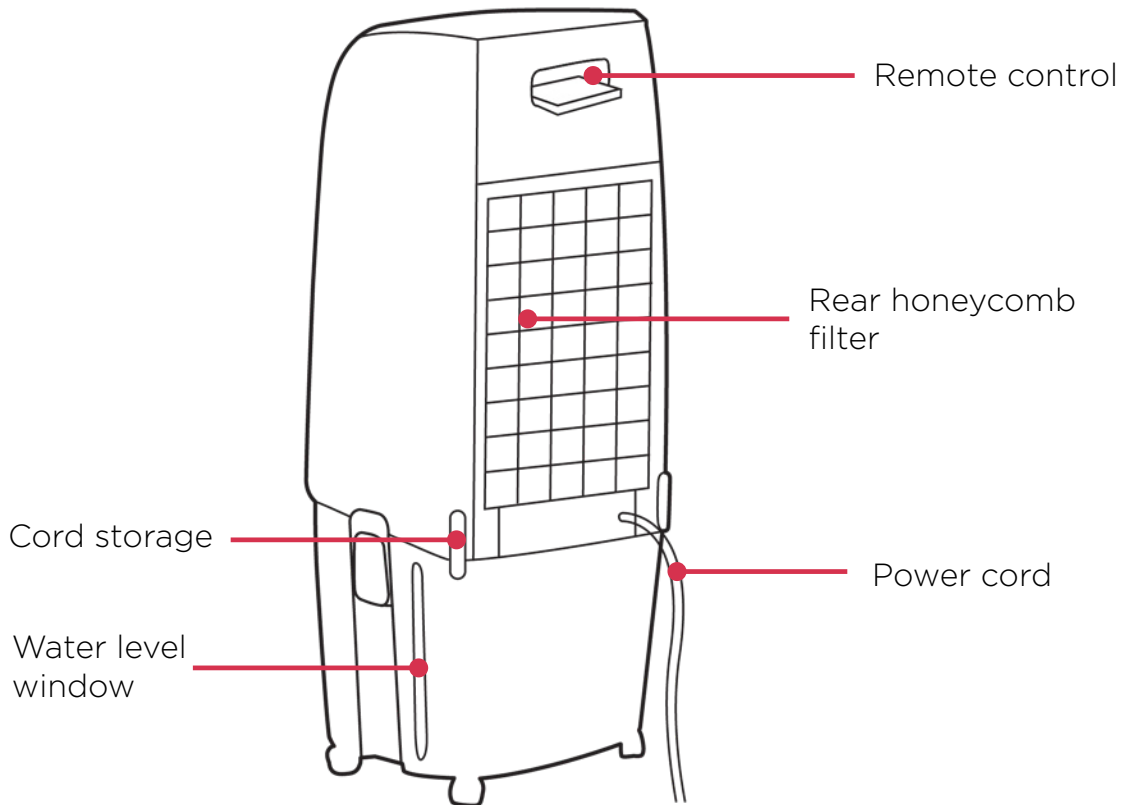
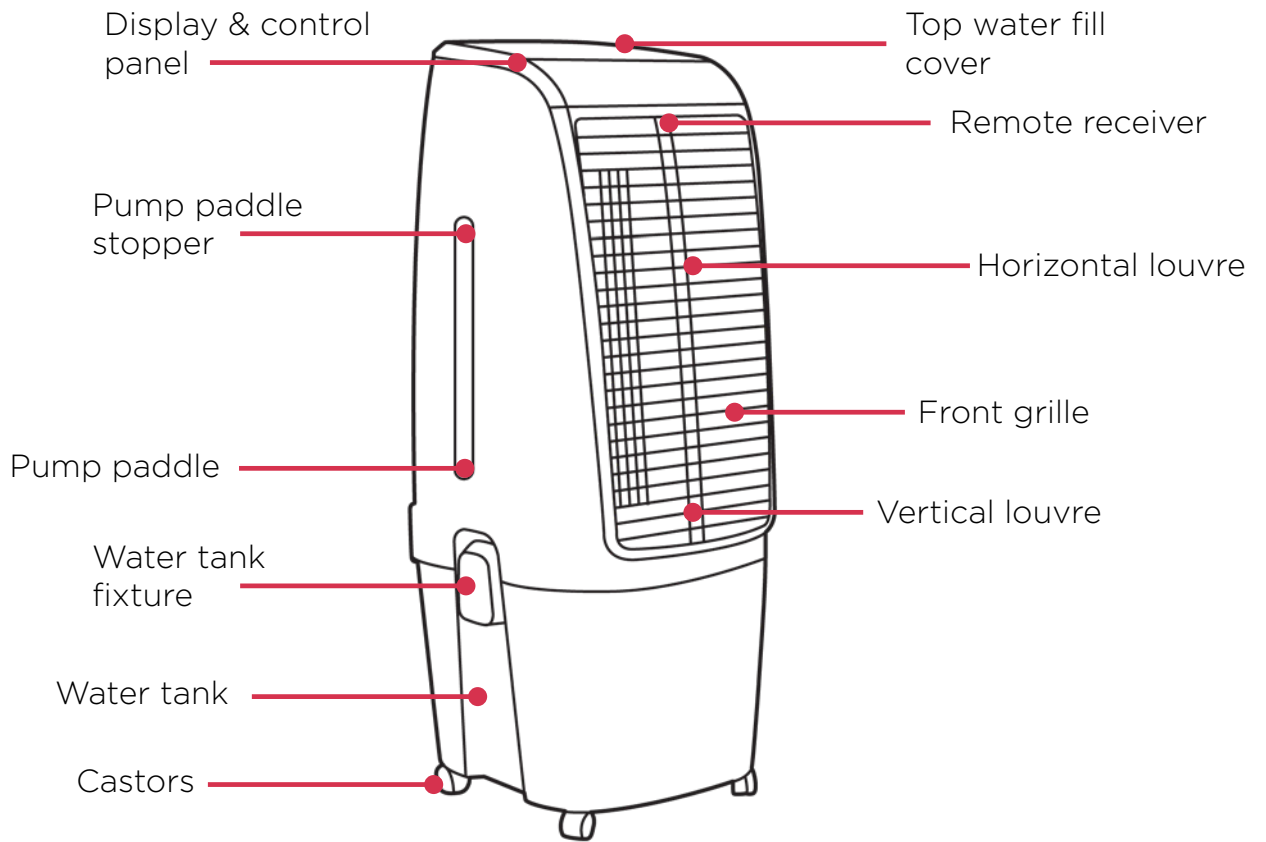

Control Panel



Functions

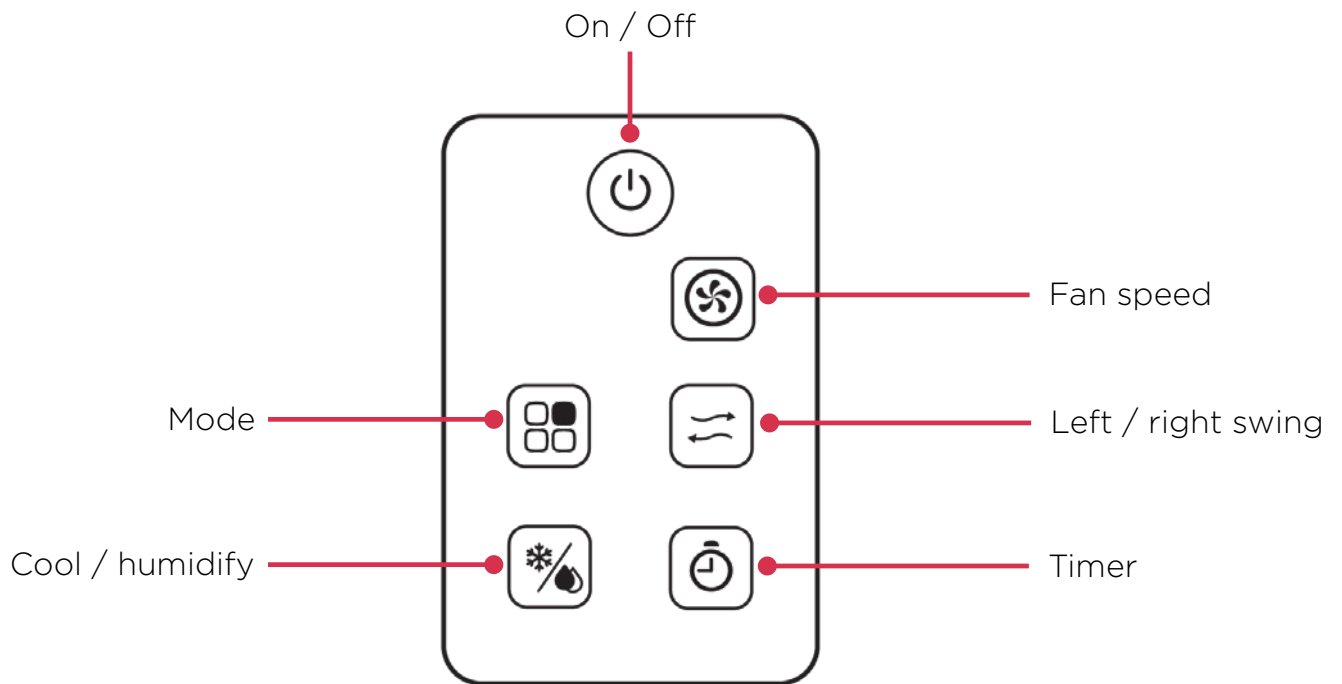

Assembly

IMPORTANT!

First remove the pump paddle stopper as shown below, then slide the pump paddle to the bottom. This is so the pump extends down into the tank for cooling/humidification.

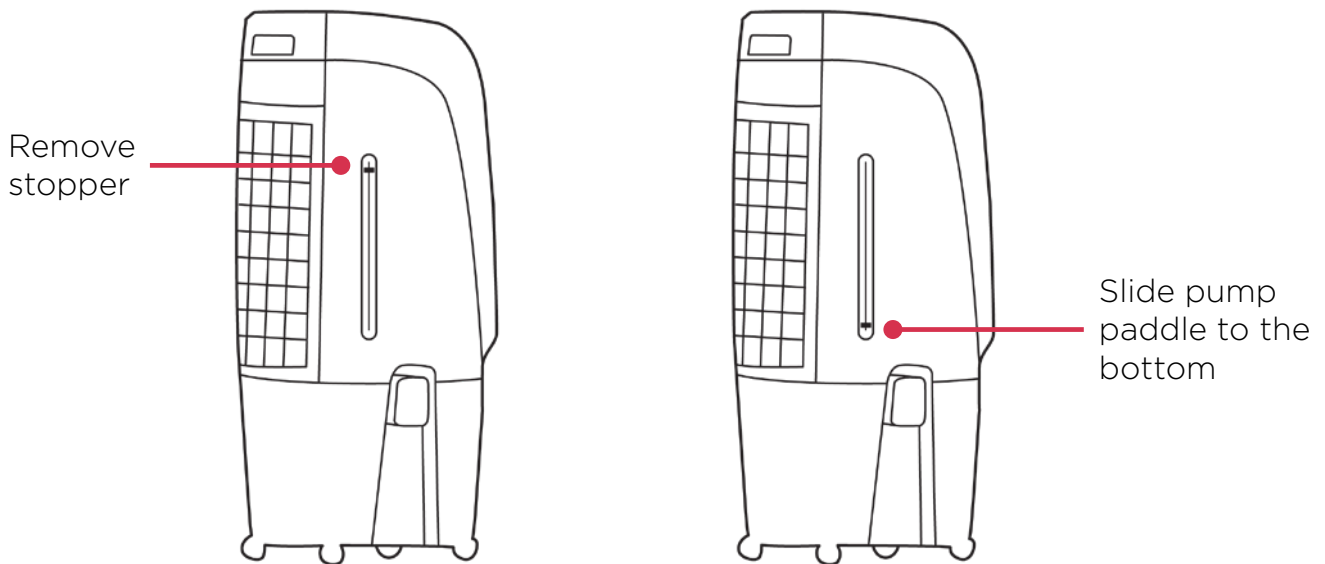

Functions

Note: The buzzer beeps twice when the power supply is first turned on. The unit is in 'standby' until the On/Off button is pressed.

ON/OFF

Press the **ON/OFF** button to turn the unit **ON**. The default settings when first turned on are; medium fan speed, normal mode, and no timer.

To turn the unit **OFF** press this button again. The unit may take a few seconds to power off completely.

FAN SPEED

The **FAN SPEED** can be selected in the following sequence: silent > low > medium > high. The selected fan speed LED indicator light will illuminate accordingly.

COOL / HUMIDIFY

Press this button once to turn on the **COOL / HUMIDIFY** function, the pump will start and the **COOL / HUMIDIFY** LED will illuminate. Press this button again to turn off the cooling function, and to use as a fan only.

LEFT / RIGHT SWING

Press this button to turn on the **SWING** function, the louvres will move left to right and the **SWING** LED indicator light will illuminate. Press the button again to turn off the swing function.

TIMER

The **TIMER** can be set via the following sequence: 1H > 2H > 4H > 8H > Off. The time isn't accumulated and the MAX timer is 8H. The set time will be indicated by the LED lights on the display panel.

MODE

The default mode after turning "On" is normal. Press this button to select modes in this sequence: normal > natural > sleep. The **MODE** indicator light will illuminate accordingly (NOTE: the natural and sleep modes are unavailable if silent fan speed is selected).

Normal: Constant wind speed.

Natural: Changing wind speeds (the indicator lights only show the initial wind speed when the speed changes, and other changes are not indicated).

Sleep: In natural sleep mode, the wind speed LED changes with the 30-minute cycle change, but does not indicate with the change of natural wind.

High: 30 minutes high speed natural wind > 30 minutes medium level natural wind > low level natural wind (until turned off).

Medium: 30 minutes medium level natural wind > low level natural wind (until turned off).

Low: Low level natural wind (until turned off).

Other functions

Environmental protection function:

If no operation is detected within 60 seconds, all LED's dim to a semi-bright light. When operation is detected, the LED's enter full brightness immediately.

Water level protection function:

When the cooling function is first turned on, the water pump works for 50 seconds. If the low water is detected, then the pump will stop working and a buzzer alarm sounds for 10 seconds.

Separation power off function:

When the water pump is removed from the tank, the unit will turn off immediately.

Air dry function

If the honeycomb filter needs to be dried after using the cooler/humidifier function (e.g. before packing the unit away), press and hold the "fan speed" button on the panel for 3 seconds to activate the air dry function.

When the air dry function is activated, the fan speed turns to high speed automatically and runs for 20 minutes. During 'Air dry', other functions are turned off and can not be used. The high fan speed indicator will illuminate and flash for the 20 minute duration.

If the "On/Off" button is pressed before the 20 minutes are complete, the remaining 'Air dry' time won't be saved, and you'll need to start again.

Power failure memory function:

- If there is a power failure during operation, when power resumes, the unit will automatically turn back on and beep ten times. After 30 seconds the unit will resume the last settings it was operating in.
- To speed up the process, press the "On" button within 30 seconds of the power being restored, and it will operate immediately.

Prevent long time use

The unit turns off automatically after continuously working for 15 hours. This function can prevent the unit from running for long periods, especially if the user forgets to turn the unit "Off".

Uninterrupted memory function:

When the unit is turned on and in a running state, it will resume the same functions before it was last turned "Off" (except sleep and natural mode). The timer also has an uninterrupted memory function.

Filling the water tank

In order to use the cooling/humidifier function, you need to fill the water tank. For your convenience, the water tank can be filled from the top of the unit saving removing the water tank.

Filling from the top

Open the water cover, and slowly pour filtered/clean water into the compartment with a jug (as per below), and then close the water cover.

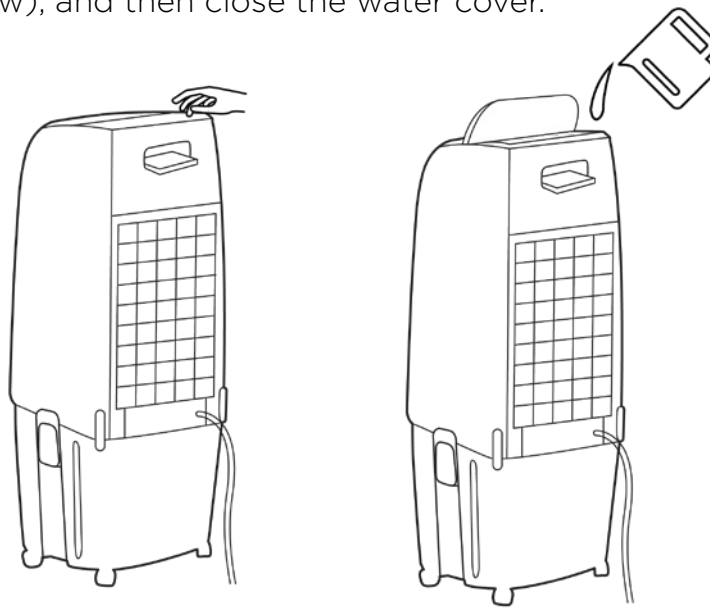

Removing & filling the water tank

Loosen the water tank fixtures on both sides of the unit, and slide the pump paddle up, to move the pump to the top of the tank. The top part of the unit should be free to detach from the water tank. Slowly pour water into the water tank with a jug.

Once the water tank has been filled to the MAX fill line, replace the top part of the unit back onto the water tank, fasten the water tank fixtures, and slide the pump paddle back into the water tank.

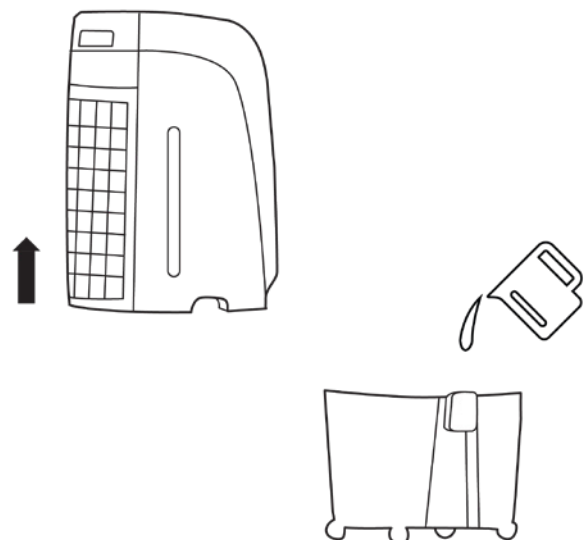

OTHER USES

This unit can also be used as a fan. Before using as a fan only, use the 'air dry' function to completely dry the unit and the honeycomb filter. Follow steps 'Removing & filling the water tank', and remove the water tank from the top part of the unit. Once the upper part is removed, it can be used as a normal fan, ensuring it is placed on a stable level surface.

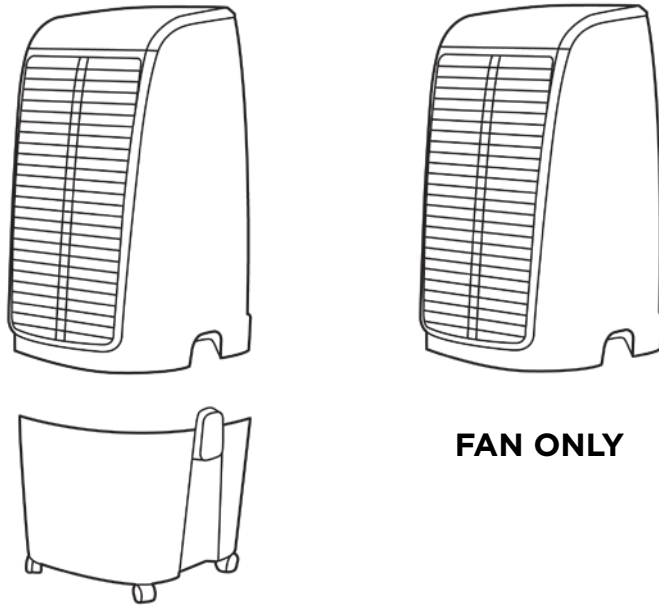

Using the Remote Control

1. Open the battery cover of the remote control, and insert a 3V CR2032 battery.
2. Please point to the receiver when using the remote control.
3. If the battery voltage is low, please open the battery cover as per the diagram and replace with a new battery (CR2032). Then replace the battery cover.

Your unit is designed to remove dirt and other atmospheric impurities by drawing air through the air filter. **DO NOT** block the air filter, as this will impair the efficiency of the unit. Avoid pushing the unit up against a wall or operating it in close proximity to long window drapes or furnishings as this will also impair the unit's air flow and efficiency.

Water Tank

The water tank should be cleaned regularly. If not cleaned, deposits may build up affecting the efficiency of the unit. Cleaning the tank with mild soapy water once every 6 months is recommended. To do this, following the steps bellows:

1. Disconnect the appliance from the main supply.
2. Completely remove the water tank from the unit.
3. Remove any deposits or dirt from the tank with a mild, soapy detergent and cloth.
4. Flush the tank with clean water.
5. Reverse the procedure and make sure the tank lock is in place.

Outside Cabinet

1. Turn the unit OFF and disconnect the appliance from the power supply.
2. Remove any dust build up with a soft brush.
3. Wipe the surface of the unit with a soft damp cloth. Mild detergent can be used for any stubborn marks.

Do not use abrasive sponges, scouring pads, or a stiff brush to clean the

IMPORTANT

The control panel and other parts must not come into contact with water or any other liquids.

Storage

If not using the unit for an extended period of time. After cleaning please:

- Turn the unit off, unplug and take care of the mains lead & plug.
- Cover the unit and store it upright in a location where it will not receive direct sunlight. NB- Prolonged exposure to direct sunlight will discolour the enclosure.

Maintenance

If the unit fails to operate efficiently, is broken or other problems arise, unplug and do not operate. Ask for advice by calling your local after sales service agent or the Customer Care Centre on 1300 556 816 (AU) / 0800 666 2824 (NZ).

Warranty

Please refer to the warranty card in the box for warranty information. For any troubleshooting advice, please contact the relative Customer Care Centre below.

Glen Dimplex Australia Pty Ltd

1340 Ferntree Gully Road,
Scoresby 3179, Victoria
Australia
Ph: 1300 556 816

Glen Dimplex New Zealand Ltd

38 Harris Road, East Tamaki,
Auckland 2013
New Zealand
Ph: 0800 666 2824



Recycling: Do not dispose of electrical appliances as unsorted municipal waste. Use separate collection facilities. Contact your local government for information regarding the collection systems available. If electrical appliances are disposed of in landfills or dumps, hazardous substances can leak into the ground water, polluting the food chain and damaging health and well-being.



Customer Care: 1300 556 816
customer.care@glendimplex.com.au
www.dimplex.com.au

Supplied by Glen Dimplex Australia
1340 Ferntree Gully Road, Scoresby, Victoria, 3179

© Glen Dimplex Australia. All rights reserved. Material contained in this publication may not be reproduced in whole or in part, without prior permission in writing of Glen Dimplex Australia.

DCEVP20W v2