

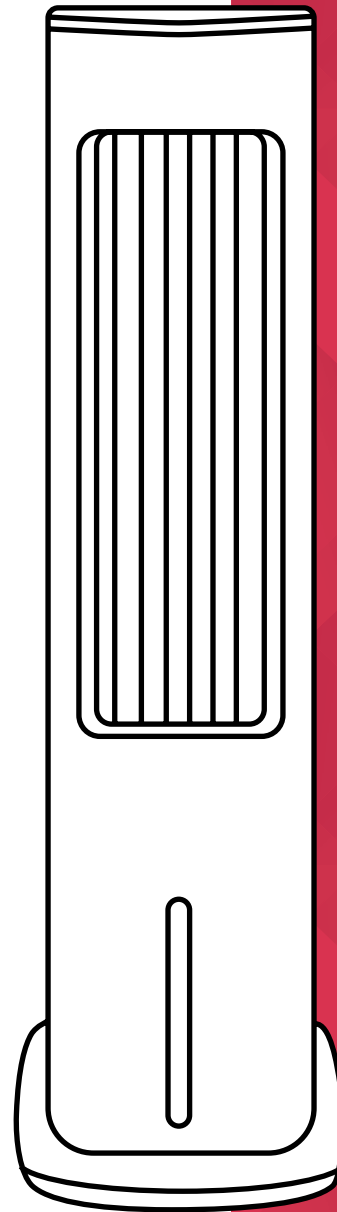

INSTRUCTION MANUAL



5L Evaporative Cooler

Model: DCEVP5BW

For domestic household use only.



IMPORTANT

THESE INSTRUCTIONS SHOULD BE READ CAREFULLY AND RETAINED FOR FUTURE REFERENCE. **Note also the information presented on the appliance**

CAUTION: FAILURE TO FOLLOW THESE INSTRUCTIONS MAY CAUSE INJURY AND/OR DAMAGE AND MAY INVALIDATE YOUR WARRANTY

Please read the operating instructions carefully before using your evaporative cooler for the first time and keep them in a safe place.

WARNING - This appliance must not be used in a bathroom.

WARNING - Do not use this appliance in the immediate surroundings of a bath, a shower or a swimming pool.

- Never immerse the appliance in water or other liquids.
- Operate this unit only on a firm, flat surface to avoid the risk of water leakage. Ensure that the unit is kept upright at all times. If the unit topples over accidentally, and it contains water, unplug the power cord immediately and ask a professional service agent to repair the product.
- Do not place on soft, unstable or non-horizontal/angled surfaces.
- Never operate the appliance if a cable or connector has been damaged, after appliance malfunction or if the appliance was dropped or is otherwise damaged.
- If the mains lead is damaged it must only be replaced by the manufacturers service agent or a similarly qualified person in order to avoid a hazard.
- Please ask a professional service agent to repair the product. Improper repair may cause danger to users. Non-specialized personnel or unauthorized repair personnel should not repair or modify the machine.
- Disconnect the appliance from mains power whenever it is not in use, before relocating it, filling it and before cleaning.
- Operate the appliance only at the voltage specified on the rating label.
- Only connect the unit to a properly installed and easily accessible socket so that you can quickly disconnect the plug if necessary. Not directly under the outlet.
- Do not connect this product to the mains using an extension lead.
- This evaporative cooler is only intended for **INDOOR RESIDENTIAL** applications. This evaporative cooler should not be used for commercial or industrial or leisure applications or in small enclosed spaces.
- Never use the mains lead as a carrying strap or pulling lead.
- To avoid a fire or electrocution hazard, **NEVER** put the cord near heat registers, radiator, stoves or heaters.
- **DO NOT** operate with wet hands, as it could lead to electric shock.
- **DO NOT** cover cord with carpeting, throw rugs, runners, or similar coverings.
- **DO NOT** route cord under furniture or appliances. Take care to position the cord away from traffic areas and where it will not be a tripping hazard.
- **DO NOT** use the unit near windows or where water collects. Rain and water **collection may lead to a risk of fire or electric shock.**

- Do not place items on the unit, and covering the outlet is strictly prohibited.
- Never insert fingers, pencils, or any other object through the grille when the fan is running.
- Only operate this appliance with a minimum of 50cm clearance all around i.e. away from walls, furniture and overhanging objects such as curtains or a shelf.
- This appliance is not intended for use by persons (including children) with reduced physical, sensory or mental capabilities, or lack of experience and knowledge, unless they have been given supervision or instruction concerning use of the appliance by a person responsible for their safety.
- Children should be supervised to ensure they do not play with the appliance.
- To prevent spillage, empty the water tank before lifting or relocating the appliance.
- **WARNING:** To avoid danger of suffocation please remove all packaging materials particularly plastic and EPS and keep these away from vulnerable people, children and babies.
- **NEVER** drop or insert any object or fingers into any openings.
- Do not use the appliance in locations where paint, petrol or other flammable liquids are used or stored.
- Do not use bug sprays or other flammable cleansers/vapour sprays on or around the unit.
- To prevent accidental injury or damage to the unit, please do not insert any foreign matter into the air inlet and outlet.
- This machine has a safety switch. If the honeycomb filter support has not been installed well, the unit will not work correctly. When the machine is working, do not remove the honeycomb filter frame.
- Always switch off the unit and take the plug out of the socket:
 - If you are not using the unit
 - Before you clean or carry out maintenance on the unit
 - If a fault occurs
 - During filling
 - In the event of an electrical storm
- Avoid electromagnetic interference. Keep the unit at least 1 metre away from electrical appliances such as televisions & radios.
- At any time the water level in the tank shall not exceed "MAX" (maximum) scale, and during humidification, the total water level in the tank shall be controlled, and shall not be below "MIN" (minimum) scale.
- When cleaning the unit, apply a damp cloth (or add a little mild detergent) to wipe, and never use a corrosive cleaning agent or solvent for cleaning. Never rinse the unit with water.
- When the unit is running, do not knock at or shock the unit body forcibly or it may lead to automatic shutdown, in which case simply restart the unit.
- In summer, the water in the tank may easily deteriorate and generate odour, please change the water regularly. If the indoor temperature is below zero in winter humidification, it is best to use warm water for humidification.
- Be aware that high humidity levels may encourage the growth of biological organisms in the environment.
- Do not permit the area around the humidifier to become damp or wet. If dampness occurs, turn the output of the humidifier down. If the humidifier output volume cannot be turned down, use the humidifier intermittently. Do not allow absorbent materials, such as carpeting, curtains, drapes, or tablecloths, to become damp.



Exposed to the weather outdoors



Near water



If the power cable wires are frayed or cut



Where small children may be left unattended

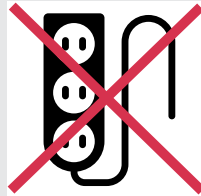

If an extension lead may become overloaded



Where the power cable may be damaged



On a slope or uneven surface



Where there is risk of fire or close to a naked flame



Where it may be damaged by chemicals



Where there is a risk of interference by foreign objects



This product is not made for DIY repair



If there is a risk of water falling on the unit

Specification

Model no.	DCEVP5BW
Colour	White/Black
Power supply	220-240V~50Hz
Rated power	55W
Speed settings	3
Modes	3 (natural, normal & sleep)
Turbo air speed	6.5m/min
Water tank capacity	5L
Remote control	Y
Timer	7 hours
Swing function	Y
Controls	Button with LED display
Water consumption	0.5L/h
Weight (net)	6.2kg
Dimensions (w x d x h)	295 x 230 x 850mm

- For greater precision, please always refer to the rating label placed on the product.

Parts

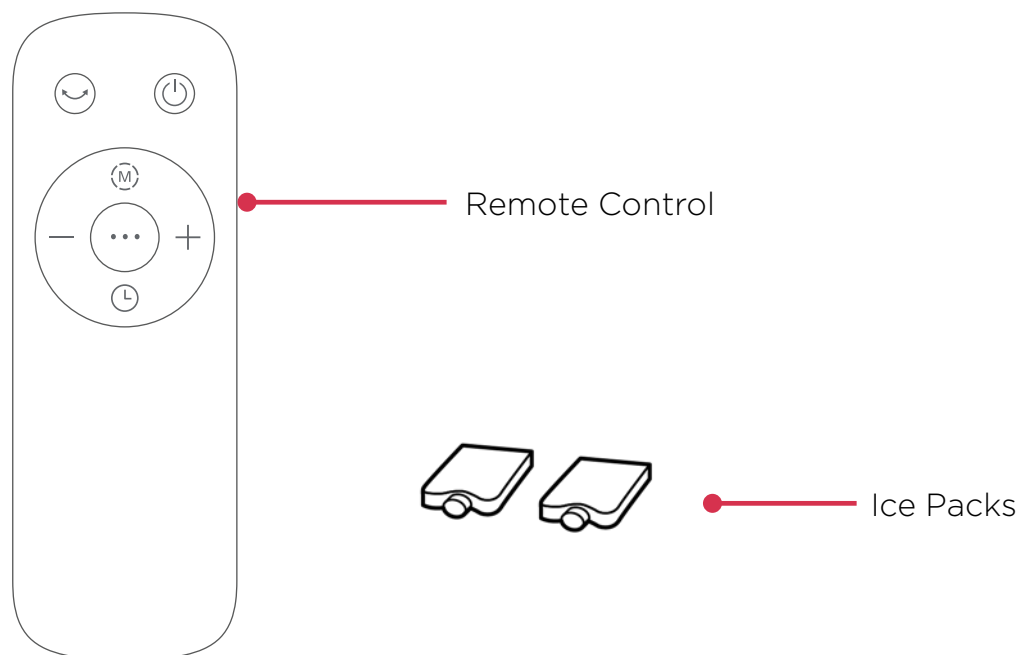
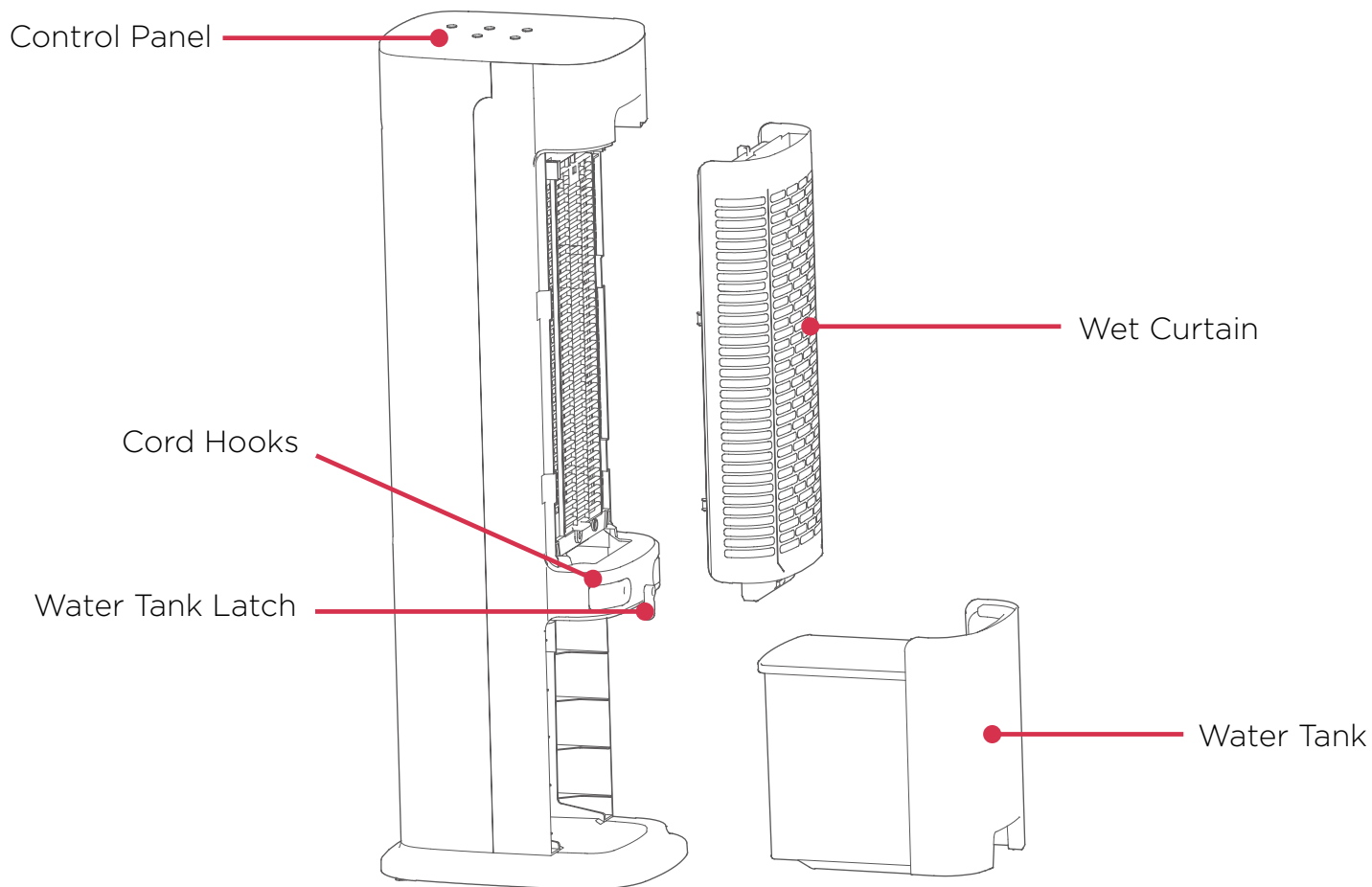

Display Panel

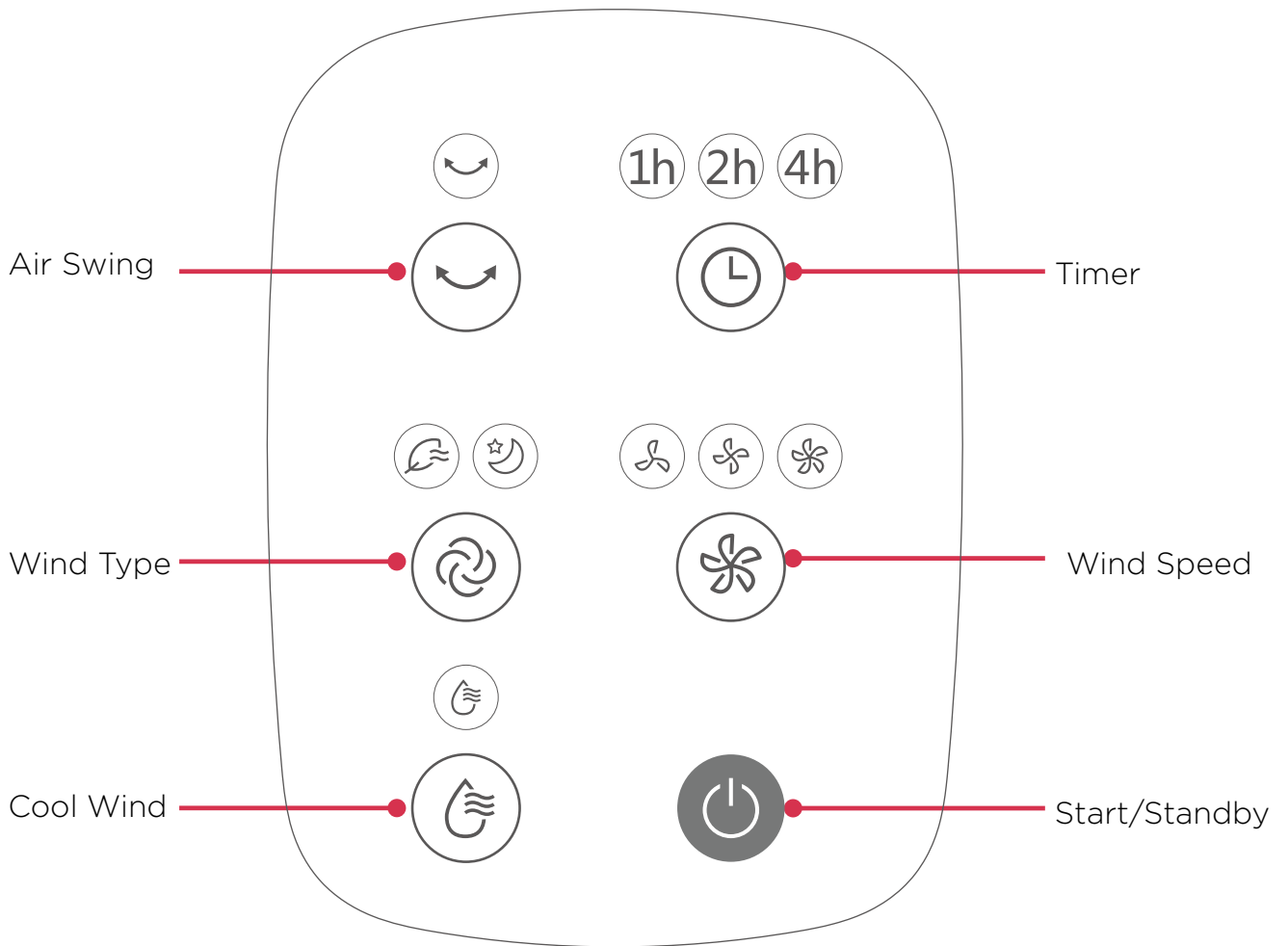

Remote Control

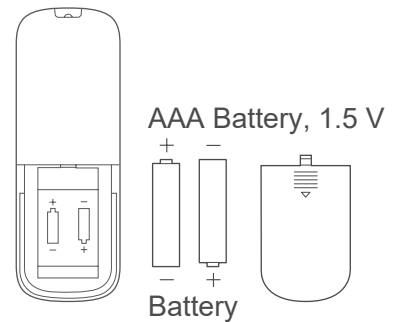
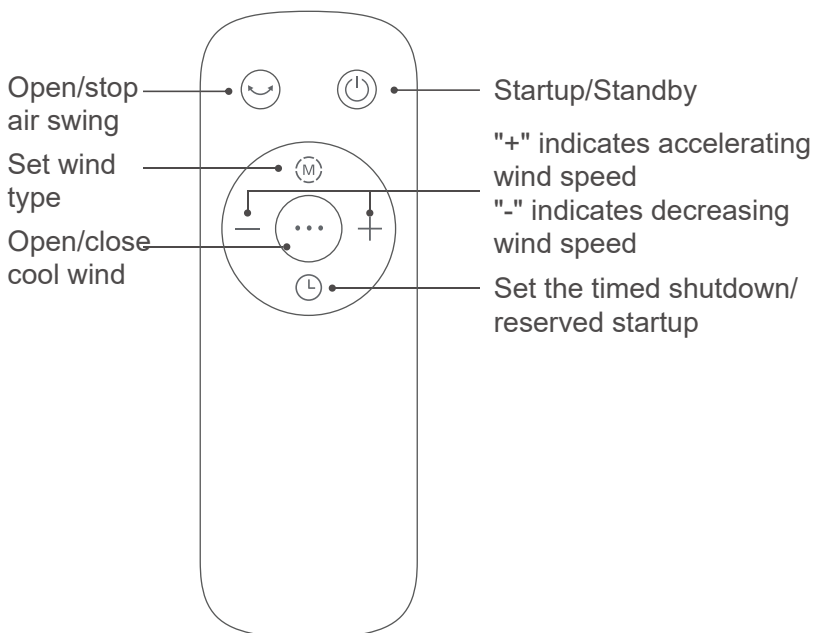

Functions

START/STANDBY

This button is used to switch the unit ON and OFF.

AIR SWING

This button is used to activate the air swing (oscillation) function. This unit has a range of 60°.

WIND SPEED

This control gives you the option of switching between low, medium and high speed.

WIND TYPE

Press the button to select among these three types of wind: Normal, Sleep and Natural. The indicator light will show which type of wind has been selected.

TIMER

This evaporative cooler comes with an 7 hour TIMER that allows you to pre-set the machine to switch off or switch on automatically, in hourly intervals.

To operate, simply select the number of hours ahead you wish the machine to switch off or on. If you want it to run continuously, ensure the TIMER mode is deselected.

COOL WIND

Press this button to turn on or off the COOL WIND function. This is more effective in dry, hot weather. If the indicator light flashes, water is required to be added. After stopping the cool wind function for 2 minutes, pull out the water tank to replace water, as water in the pipeline and wet curtain flows back to the water tank.

Set Up

IMPORTANT: Never remove the water tank or open the cover when the unit is ON and operational

ICE PACKS

The unit comes with 2 x ice packs. Ice packs are used to increase the cooling capacity. Please place the ice packs in the freezer before use. It takes about 4 hours to freeze completely - depending on the freezer.

1. Once the ice pack is frozen, open the water tank as instructed on page 10 and insert the ice packs. Fill the water tank below the maximum mark.
2. Always ensure the unit is OFF before placing or removing the ice pack.

1. Remove the unit from its packaging
2. To begin using the cooling function, open and remove the water tank located at the back of the unit and fill to the MAX fill line.
3. For extra cooling power, place an ice pack into the water tank.
4. Press the START/STANDBY button to start the appliance.
5. The unit will operate initially on a continual basis. If a set period of operation is required, please follow TIMER instructions on the previous page.
6. Operate the AIR SWING button for the unit to oscillate, as required.
7. To switch the unit off at any time, press the START/STANDBY button.

Precautions

- Do not overfill the water tank (check the MAX fill line).
- Only fill the water tank half full, when using the ice packs.
- Use only cold, clean filtered water.
- The unit is equipped with a water shortage protection.
- Do not allow the same water to sit in the machine for a prolonged period.
- It is recommended that any water left in the machine for 3 days or more be removed and replaced with clean water.
- The control panel must not come in contact with water or any other liquids.

Using the Remote Control

1. Slide open the battery cover of the remote control, and insert 2 x AAA (1.5V) batteries.
2. Please point to the receiver when using the remote control.
3. If the battery voltage is low, please open the battery cover as per the diagram on page 7 and replace with two new batteries (AAA). Then replace the battery cover.

Your unit is designed to remove dirt and other atmospheric impurities by drawing air through the wet curtain. DO NOT block the wet curtain as this will impair the efficiency of the unit. Pushing the unit up against a wall or operating it in close proximity to long window drapes will also impair the unit's air flow and efficiency.

Wet Curtain

- This is easily accessible by removing the rear screen.
- Firstly, rotate the bottom buckle that secures the wet curtain and remove it.
- Disconnect the unit from the main supply. Gently wash the wet curtain in mild, soapy water, dry and replace. Be sure to re-fit the rear screen securely. No special tools are required for this.

Water Tank

The water tank should be cleaned regularly. If not cleaned, deposits may build up affecting the efficiency of the unit. Cleaning the tank with mild soapy water once every 6 months is recommended. To do this, follow the steps below:

1. Disconnect the appliance from the power supply.
2. Move the latch to the horizontal position and completely remove the water tank from the unit.
3. Slowly remove the water tank. Unscrew the rotary knob in the (-) position 90 degrees anti-clockwise to the (I) position to separate the water pump module from the water tank. Remove any deposits or dirt from the tank with a mild, soapy detergent and cloth. **Note:** for hard water areas use a citric acid solution to descale & clean the tank. Mix 1 part citric acid to 20 parts water.
4. Flush the tank with clean water.
5. Reverse the procedure and make sure the water tank front hook is securely in the slot and rotate the rotary knob 90 degrees clockwise to re-engage the water pump module to the water tank. Move the latch position back the vertical position of the rear grill to secure the water tank.

Outside Cabinet

1. Turn the unit OFF and disconnect the appliance from the power supply.
2. Remove any dust build up with a soft brush.
3. Wipe the surface of the unit with a soft damp cloth. Mild detergent can be used for any stubborn marks.

Do not use abrasive sponges, scouring pads, or a stiff brush to clean the unit.

IMPORTANT

The control panel and other parts must not come into contact with water or any other liquids.

Storage

Storage

If you are not using the unit for an extended period of time. After cleaning please:

- Turn the unit off, unplug and take care of the mains lead & plug.
- The unit is equipped with hooks at the rear of the unit for the power cord to wind around and be secured.
- Cover the unit and store it upright in a location where it will not receive direct sunlight. NB- Prolonged exposure to direct sunlight will discolour the enclosure.

Maintenance

If the unit fails to operate efficiently, is broken or other problems arise, unplug and do not operate. Ask for advice by calling your local after sales service agent or the Customer Care Centre on 1300 556 816 (AU) / 0800 666 2824 (NZ).

Warranty

Please refer to the warranty card in the box for warranty information. For any troubleshooting advice, please contact the relative Customer Care Centre below.

Glen Dimplex Australia Pty Ltd

8 Lakeview Drive,
Scoresby 3179, Victoria
Australia
Ph: 1300 556 816

Glen Dimplex New Zealand Ltd

38 Harris Road, East Tamaki,
Auckland 2013
New Zealand
Ph: 0800 666 2824

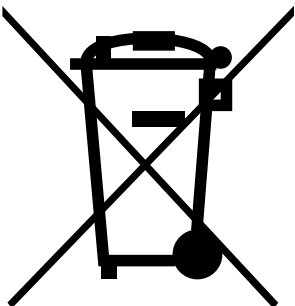

Recycling: Do not dispose of electrical appliances as unsorted municipal waste. Use separate collection facilities. Contact your local government for information regarding the collection systems available. If electrical appliances are disposed of in landfills or dumps, hazardous substances can leak into the ground water, polluting the food chain and damaging health and well-being.



Customer Care: 1300 556 816
customer.care@glendimplex.com.au
www.dimplex.com.au

Supplied by Glen Dimplex Australia
8 Lakeview Drive, Scoresby, Victoria, 3179

© Glen Dimplex Australia. All rights reserved. Material contained in this publication may not be reproduced in whole or in part, without prior permission in writing of Glen Dimplex Australia.