

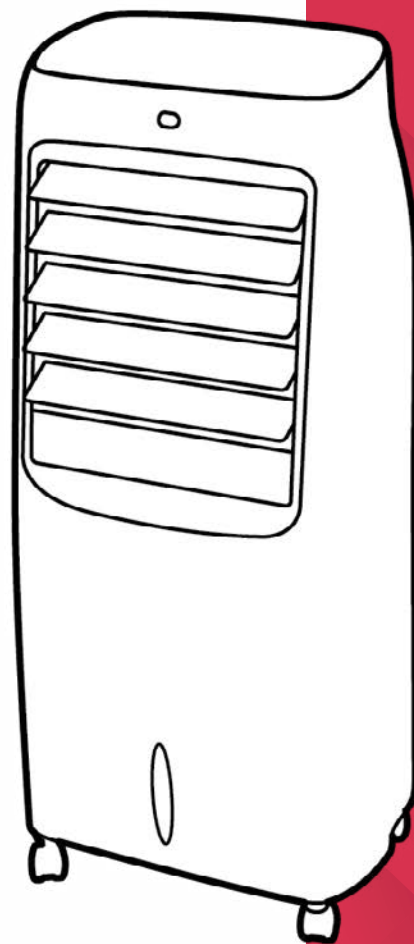

INSTRUCTION MANUAL



6L Evaporative Cooler

Model: DCEVP6

For domestic household use only.



IMPORTANT

THESE INSTRUCTIONS SHOULD BE READ CAREFULLY AND RETAINED FOR FUTURE REFERENCE. **Note also the information presented on the appliance**

CAUTION: FAILURE TO FOLLOW THESE INSTRUCTIONS MAY CAUSE INJURY AND/OR DAMAGE AND MAY INVALIDATE YOUR WARRANTY

Please read the operating instructions carefully before using your evaporative cooler for the first time and keep them in a safe place.

WARNING – This appliance must not be used in a bathroom.

WARNING – Do not use this appliance in the immediate surroundings of a bath, a shower or a swimming pool.

- Never immerse the appliance in water or other liquids.
- Operate this unit only on a firm, flat surface to avoid the risk of water leakage. Ensure that the unit is kept upright at all times.
- Do not place on soft, unstable or non-horizontal/angled surfaces.
- Never operate the appliance if a cable or connector has been damaged, after appliance malfunction or if the appliance was dropped or is otherwise damaged.
- If the mains lead is damaged it must only be replaced by the manufacturers service agent or a similarly qualified person in order to avoid a hazard.
- Please ask a professional service agent to repair the product. Improper repair may cause danger to users.
- Disconnect the appliance from mains power whenever it is not in use, before relocating it, and before cleaning.
- Operate the appliance only at the voltage specified on the rating label.
- Only connect the unit to a properly installed and easily accessible socket so that you can quickly disconnect the plug if necessary.
- Do not connect this product to the mains using an extension lead.
- This evaporative cooler is only intended for **INDOOR RESIDENTIAL** applications. This evaporative cooler should not be used for commercial or industrial or leisure applications or in small enclosed spaces.
- Never use the mains lead as a carrying strap or pulling lead.
- To avoid a fire or electrocution hazard, **NEVER** put the cord near heat registers, radiator, stoves or heaters.
- **DO NOT** cover cord with carpeting, throw rugs, runners, or similar coverings.
- **DO NOT** route cord under furniture or appliances. Take care to position the cord away from traffic areas and where it will not be a tripping hazard.
- **DO NOT** use the unit near windows or where water collects. Rain and water collection may lead to a risk of fire or electric shock.
- Only operate this appliance with a minimum of 50cm clearance all around i.e. away from walls, furniture and overhanging objects such as curtains or a shelf.

- This appliance is not intended for use by persons (including children) with reduced physical, sensory or mental capabilities, or lack of experience and knowledge, unless they have been given supervision or instruction concerning use of the appliance by a person responsible for their safety.
- Children should be supervised to ensure they do not play with the appliance.
- To prevent spillage, empty the water tank before lifting or relocating the appliance.
- **WARNING:** To avoid danger of suffocation please remove all packaging materials particularly plastic and EPS and keep these away from vulnerable people, children and babies.
- **NEVER** drop or insert any object or fingers into any openings.
- Do not use the appliance in locations where paint, petrol or other flammable liquids are used or stored.
- If the supply cord is damaged, it must be replaced by the manufacturer, its service agent or similarly qualified persons in order to avoid a hazard.
- Do not use bug sprays or other flammable cleansers/vapour sprays on or around the unit.
- Always switch off the unit and take the plug out of the socket:
 - If you are not using the unit
 - Before you clean or carry out maintenance on the unit
 - If a fault occurs
 - In the event of an electrical storm.
- Avoid electromagnetic interference. Keep the unit at least 1 metre away from electrical appliances such as televisions & radios.

WARNING - KEEP BATTERIES OUT OF REACH OF CHILDREN

- Swallowing may lead to serious injury in as little as 2 hours or death, due to chemical burns and potential perforation of the oesophagus.
- If you suspect your child has swallowed or inserted a button battery immediately call the 24-hour Poisons Information Centre on 13 11 26 (in Australia) or 0800 764 766 (in New Zealand) for fast, expert advice.
- Examine devices and make sure the battery compartment is correctly secured, e.g. that the screw or other mechanical fastener is tightened. Do not use if the compartment is not secure.
- Dispose of used button batteries immediately and safely. Flat batteries can still be dangerous.



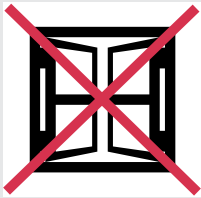

Exposed to the weather outdoors



Near water

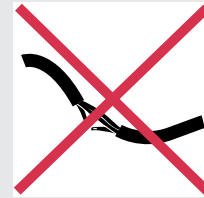

If the power cable wires are frayed or cut



Where small children may be left unattended

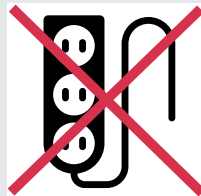

If an extension lead may become overloaded



Where the power cable may be damaged



On a slope or uneven surface



Where there is risk of fire or close to a naked flame



Where it may be damaged by chemicals



Where there is a risk of interference by foreign objects



This product is not made for DIY repair



If there is a risk of water falling on the unit

Specification

Model no.	DCEVP6
Colour	White/Black
Power supply	220-240V~, 50Hz
Rated power	110W
Speed settings	3
Modes	3 (natural, normal & sleep)
Turbo air speed	10m/s
Water tank capacity	6L
Remote control	Y
Timer	0-8 hours
Swing function	Y
Controls	Button with LED display
Max. room size	20m ²
Water consumption	1.2L/h (high speed)
Weight (net)	7.1kg
Dimensions (w x d x h)	279 x 355 x 825mm

- For greater precision, please always refer to the rating label placed on the product.

Parts

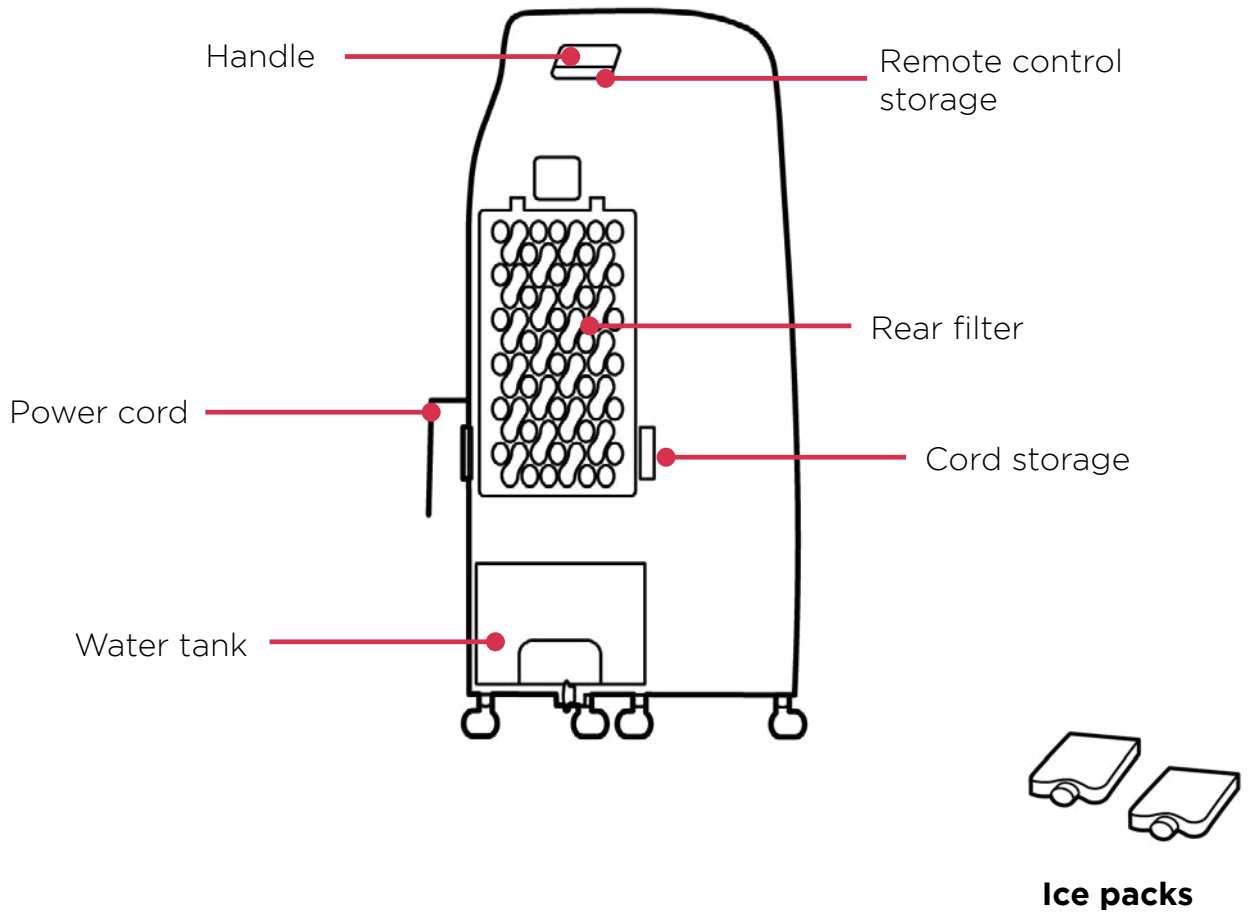
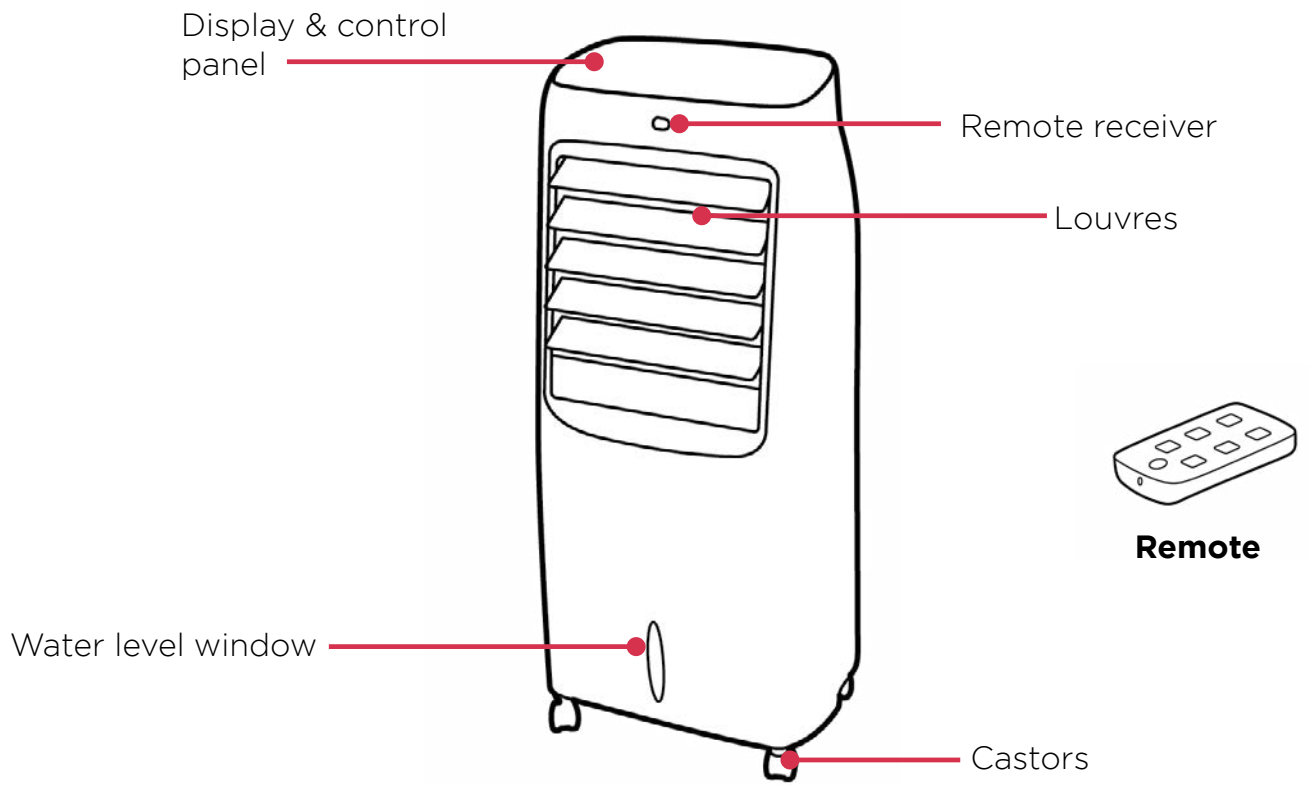

Display Panel

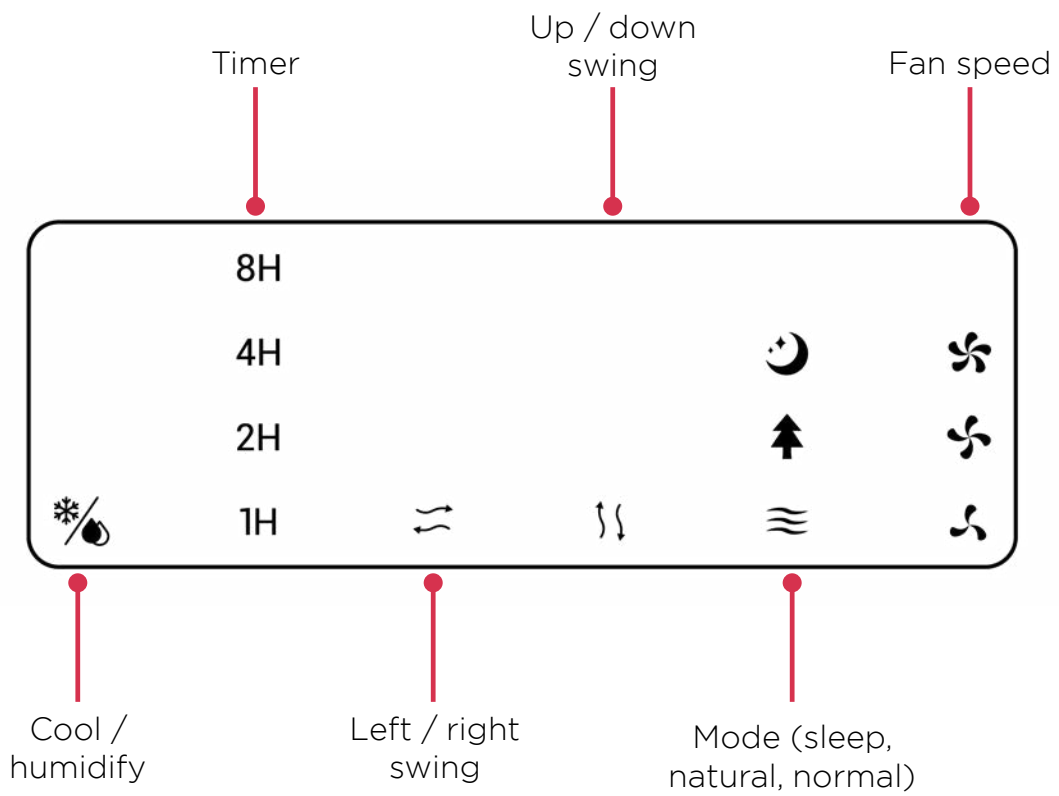

Functions

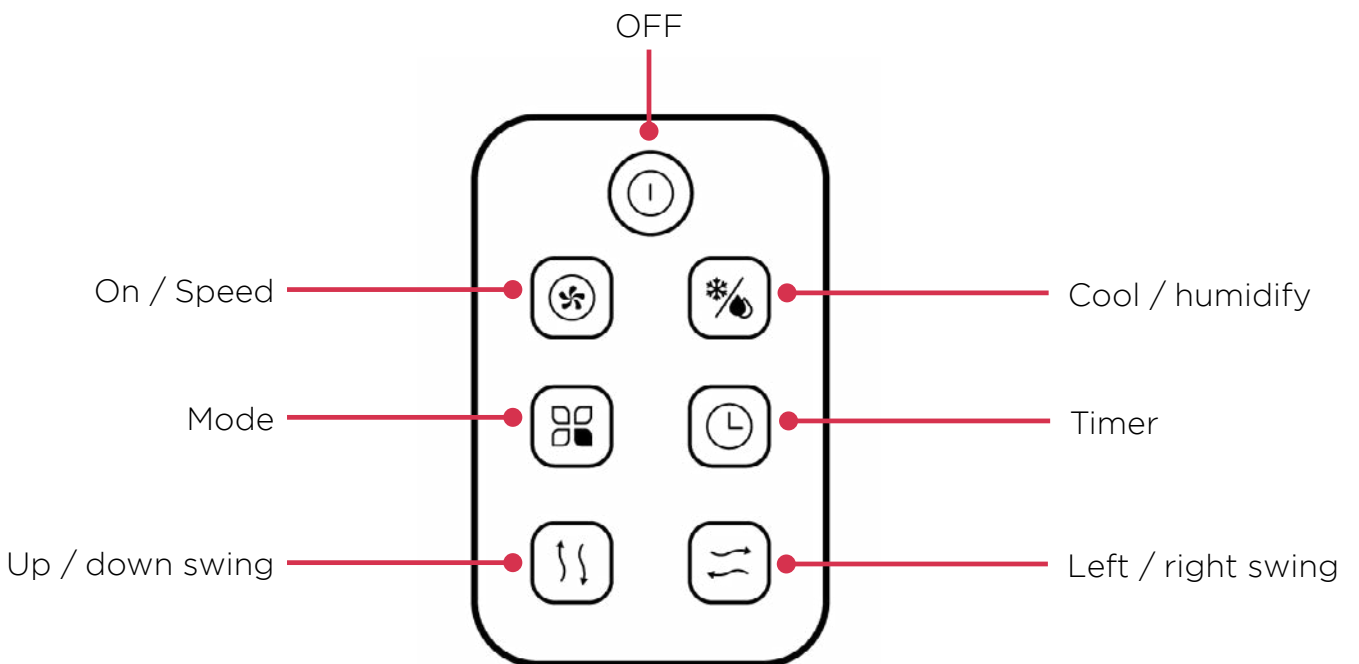

ON / SPEED

This button is used to switch the unit **ON** and to control the speed. By pressing this button, you can regulate the airflow from **LOW**, **MEDIUM** or **HIGH** depending on your needs. The unit automatically starts in **MEDIUM** speed.

MODE

This button is used to switch between pre-set operating modes. By pressing the **MODE** button, you can regulate the mode from **NORMAL**, **NATURAL** or **SLEEP** depending on your needs. The unit automatically starts in **NORMAL** mode.

UP / DOWN (swing)

This control gives you the option of having the horizontal louvres swing or stationary. After turning on, the louvres default to 127°. Press the **UP / DOWN** button and the louvres will swing between 60° - 127°. Press the **UP / DOWN** button again and the louvres will stay at the current angle.

LEFT / RIGHT (swing)

This control gives you the option of having the vertical louvres open or closed. Press once to turn "ON". Press again to turn "OFF".

TIMER

This evaporative cooler comes with an 8 hour **TIMER** that allows you to pre-set the machine to switch off automatically, in intervals of 1, 2, 4 or 8 hours.

To operate, simply select the number of hours ahead you wish the machine to switch off. If you want it to run continuously, ensure the **TIMER** mode is deselected.

COOL / HUMIDIFY

Press this button to turn on the **COOL / HUMIDIFY** function, the pump will start and the **COOL / HUMIDIFY** LED will illuminate. Press this button again to turn off the **COOL** function, and to use as a fan only

OFF

Press this button to switch the unit OFF.

1. Remove the unit from its packaging
2. To begin using the cooling function, open and remove the water tank located at the back of the unit and fill to the MAX fill line.
3. For extra cooling power, place an ice pack into the water tank.
4. Press the **ON/SPEED** button to start the appliance.
5. The unit will operate initially on a continual basis. If a set period of operation is required, please follow **TIMER** instructions on the previous page.
6. Select the operation **MODE** as required, by pressing the **MODE** button.
7. Operate the **LEFT / RIGHT & UP / DOWN** swing function as required.
8. To switch the unit off at any time, press the **OFF** button.

Precautions

- Do not overfill the water tank (check the MAX fill line).
- Only fill the water tank half full, when using the ice packs.
- Use only cold, clean filtered water.
- The unit is equipped with a number of safety devices, including a water shortage protection, tank removal protection & power failure protection.
- Do not allow the same water to sit in the machine for a prolonged period.
- It is recommended that any water left in the machine for 3 days or more be removed and replaced with clean water.
- The control panel must not come in contact with water or any other liquids.

Using the Remote Control

1. Open the battery cover of the remote control, and insert a 3V CR2032 battery.
2. Please point to the receiver when using the remote control.
3. If the battery voltage is low, please open the battery cover as per the diagram and replace with a new battery (CR2032). Then replace the battery cover.

Your unit is designed to remove dirt and other atmospheric impurities by drawing air through the air filter. **DO NOT** block the air filter, as this will impair the efficiency of the unit. Pushing the unit up against a wall or operating it in close proximity to long window drapes will also impair the unit's air flow and efficiency.

Rear Air Filter

- This is easily accessible by removing the rear screen and filter.
- In a smoky or dusty environment, this filter will become grey in colour after one to two months.
- Disconnect the unit from the main supply. Gently wash the filter in mild, soapy water, dry and replace. Be sure to re-fit the rear screen securely. No special tools are required for this.

Water Tank

The water tank should be cleaned regularly. If not cleaned, deposits may build up affecting the efficiency of the unit. Cleaning the tank with mild soapy water once every 6 months is recommended. To do this, following the steps belows:

1. Disconnect the appliance from the main supply.
2. Completely remove the water tank from the unit.
3. Remove any deposits or dirt from the tank with a mild, soapy detergent and cloth.
4. Flush the tank with clean water.
5. Reverse the procedure and make sure the tank lock is in place.

Outside Cabinet

1. Turn the unit OFF and disconnect the appliance from the power supply.
2. Remove any dust build up with a soft brush.
3. Wipe the surface of the unit with a soft damp cloth. Mild detergent can be used for any stubborn marks.

Do not use abrasive sponges, scouring pads, or a stiff brush to clean the

IMPORTANT

The control panel and other parts must not come into contact with water or any other liquids.

Storage

If not using the unit for an extended period of time. After cleaning please:

- Turn the unit off, unplug and take care of the mains lead & plug.
- Cover the unit and store it upright in a location where it will not receive direct sunlight. NB- Prolonged exposure to direct sunlight will discolour the enclosure.

Maintenance

If the unit fails to operate efficiently, is broken or other problems arise, unplug and do not operate. Ask for advice by calling your local after sales service agent or the Customer Care Centre on 1300 556 816 (AU) / 0800 666 2824 (NZ).

Warranty

Please refer to the warranty card in the box for warranty information. For any troubleshooting advice, please contact the relative Customer Care Centre below.

Glen Dimplex Australia Pty Ltd

1340 Ferntree Gully Road,
Scoresby 3179, Victoria
Australia
Ph: 1300 556 816

Glen Dimplex New Zealand Ltd

38 Harris Road, East Tamaki,
Auckland 2013
New Zealand
Ph: 0800 666 2824

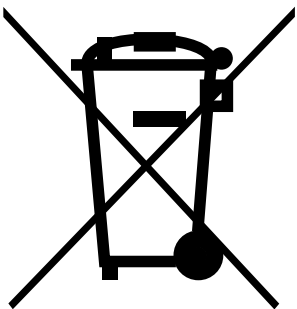

Recycling: Do not dispose of electrical appliances as unsorted municipal waste. Use separate collection facilities. Contact your local government for information regarding the collection systems available. If electrical appliances are disposed of in landfills or dumps, hazardous substances can leak into the ground water, polluting the food chain and damaging health and well-being.



Customer Care: 1300 556 816
customer.care@glendimplex.com.au
www.dimplex.com.au

Supplied by Glen Dimplex Australia
1340 Ferntree Gully Road, Scoresby, Victoria, 3179

© Glen Dimplex Australia. All rights reserved. Material contained in this publication may not be reproduced in whole or in part, without prior permission in writing of Glen Dimplex Australia.