

DC09MINI

2.6kW Portable Air Conditioner

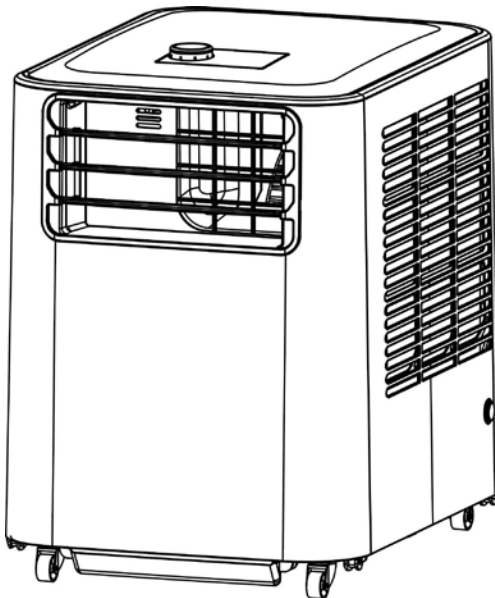

INSTRUCTION MANUAL

PLEASE READ THE INSTRUCTION MANUAL CAREFULLY BEFORE USING THE UNIT.

WARNINGS AND PRECAUTIONS	1
STRUCTURE	3
OPERATION	4
CLEANING AND MAINTENANCE	9
TECHNICAL REFERENCE DATA	10
WARRANTY	10

IMPORTANT INFORMATION

Carefully read this instruction manual before you install or use your portable air conditioner. Please retain this manual for product warranty and for future reference.

CAUTION

- Make sure the inlet and outlet vents are never blocked.
- Ensure the appliance is on a stable, even surface when operating to avoid water leakage.
- Do not operate this unit in an explosive or corrosive atmosphere.
- When switched to cooling, only operate this unit in ambient temperatures between 17°C and 35°C.
- Clean the air filter frequently to ensure efficient operation.
- To prevent compressor damage when the unit has been operating and is turned off, please wait at least 3.5 minutes before restarting.
- This unit needs to be plugged into a 220-240V ~ 50Hz AC, 7 Amp power outlet.
- Do not use any extension cords with this unit.
- This unit is for indoor operation only.
- Open the adjustable air vent and extend the exhaust pipe (and drain pipe, if fitted) to the closest window before using.
- After starting the unit, the fan will run first and the cooling display light will be flash for 3 minutes until then compressor starts working.
- Only professional technicians, manufacturers or service agents can replace a damaged power cord.
- When the batteries no longer work, they must be removed from the remote control and disposed of safely.

- This appliance is not intended for use by persons (including children) with reduced physical, sensory or mental capabilities, or lack of experience and knowledge, unless they have been given supervision or instruction concerning use of the appliance by a person responsible for their safety.
- Children should be supervised to ensure that they do not play with the appliance.
- The appliance can only be connected to power source less than 0.219Ω.
- Clear the water before move the unit.

IMPORTANT

The air conditioner must always be stored and transported upright. In case of doubt we suggest you wait at least 24 hours before operation. (Please keep the unit upright at all times)

PACKAGE CONTENTS

- Portable air conditioner
- Extendable window kit (0.48m X 2 pcs)
- Water tray

STRUCTURE



1. Controls
2. Cool air outlet
3. Cool air filter
4. Cool air inlet
5. Upper drain plug
6. Hot air outlet
7. Hot air filter
8. Hot air inlet
9. Lower drain plug

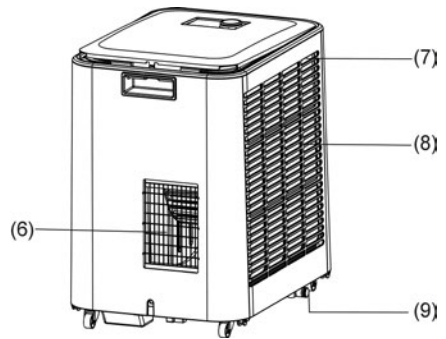
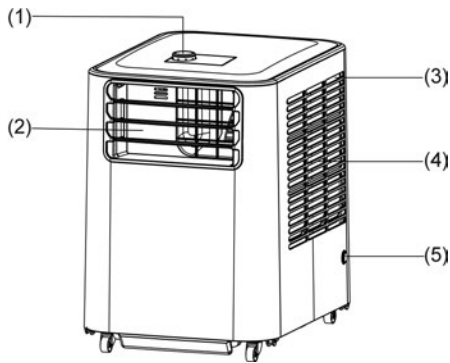

BEFORE FIRST USE

- Please read these instructions carefully before use and keep them for future reference.
- Check your local main voltage whether it is the same as stated on the appliance.
- Before using for the first time, remove any protective films or stickers from the appliance and ensure the control knob is in the “OFF” position.
- Make sure drain plugs (5 & 9) are fitted before use.

CONTROLS

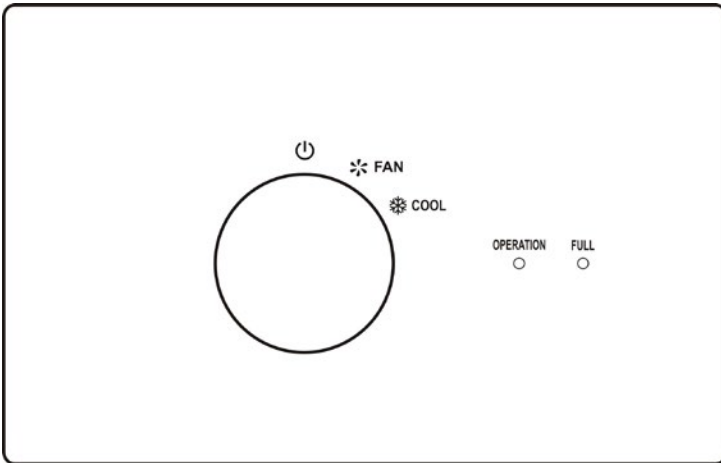

INSTALLATION

Unpack the unit and remove the exhaust hose and the hose connector from the storage compartment at the bottom of the unit.

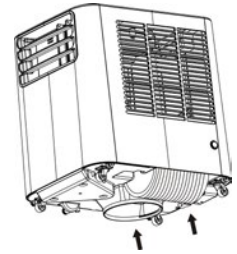

EXHAUST HOSE INSTALLATION

1. Remove the 2 x joints from the exhaust hose. See picture (1) below, and connect joint (a) and joint (b) together.
2. Attach the joint to the exhaust hose in an anticlockwise direction. See picture (2) below.

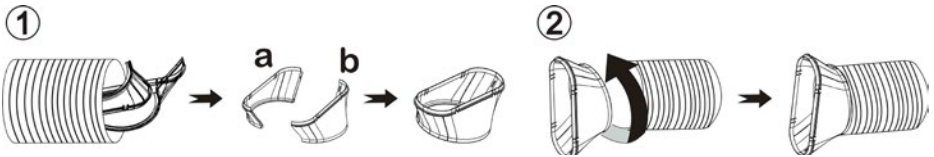

3. Rotate the exhaust hose clockwise as shown in picture (3), so that the exhaust hose can be installed on the inner joint.
4. Attach the inner joint to the product. See picture (4).

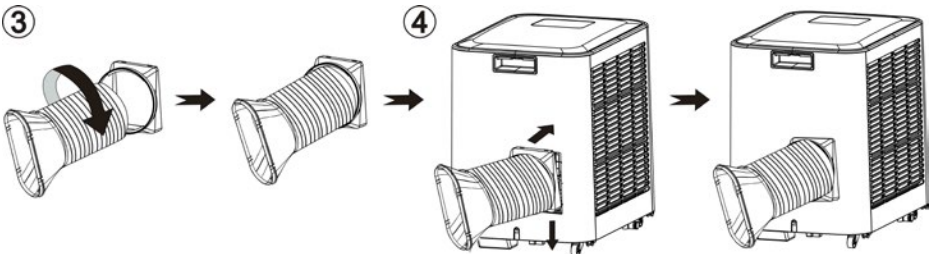

LOCATION

Ensure the portable air conditioner is installed on a flat surface with adequate space, to ensure the air inlets and outlets are not blocked.

Keep a minimum clearance of 50cm from walls and other objects. Locate the unit, so the exhaust pipe and drain hose can reach a suitable window, as shown.

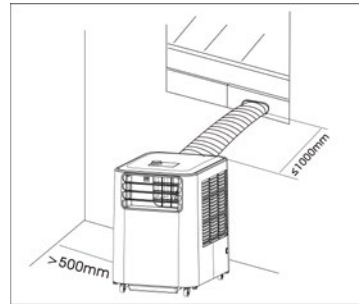

Avoid sharp bends or kinks in the exhaust pipe. The optional adjustable window slider is included to ensure the exhaust pipe is held in place (in the window) and prevents expelled hot air re-entering the room.

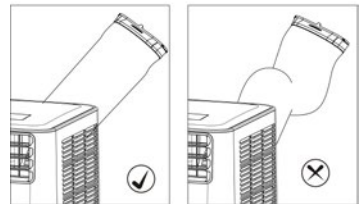

The appliance should not be used in damp areas such as a laundry or bathroom. Do not place the unit where it will be in direct sunlight, as it may overheat and turn off.

ADJUSTABLE WINDOW SLIDER KIT

The adjustable window slider kit is installed as below:

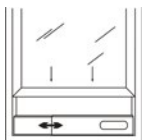

window slider kit

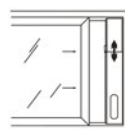
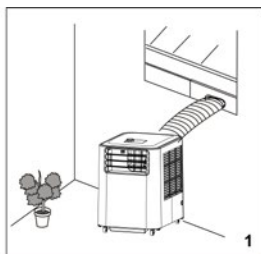

window slider kit

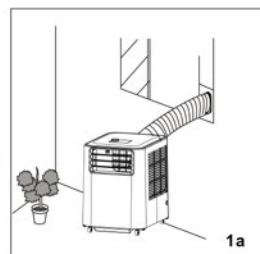

DIRECTIONS

1. Plug the unit into a suitable power outlet.
2. Turn the control knob to the “FAN” position. This will put the appliance into “FAN MODE”.
3. Turning the control knob to the “COOL” position, will put the appliance in “COOLING MODE”.
4. The “FULL” indicator light will illuminate when the internal water tank is full. Note: The unit will also stop working until the tank is emptied.
5. The “OPERATION” indicator light will illuminate when the unit is on and working.
6. Turn the control knob to the  position, to turn the unit off.

DRAINING THE WATER TANK

When the air conditioner is used, condensation may be produced that cannot be removed via the exhaust hose. This water is captured by an internal water tank. When the water tank is full, the unit will stop working and the **FULL** indicator light will turn on.

When the **FULL** indicator light has turned on, the water tank must be manually drained by following the below steps:

1. Switch off and unplug the unit.
2. Move the unit to a suitable place to drain the water. Consider placing a tray or container under the outlet to catch the water.
3. Remove the lower drain plug (9) - refer to parts illustration on page 3.
4. Slightly tilt the unit to the rear to drain the water.
5. Once the water has completely drained, replace the drain plug (9).

IMPORTANT:

- Ensure the drain plug is re-fitted to the drain outlet before use.
- Extend the exhaust back out the window before restarting the unit.

CLEANING THE FILTERS

WARNING: Always unplug the unit before moving or before any cleaning.

The filters are located on the side of the unit. Remove & clean the filters by following the below instructions.

1. Press the button near the handle. See fig. (1);
2. Remove the top panel. See fig. (2);
3. Remove the air filter by lifting upwards. See fig. (3);

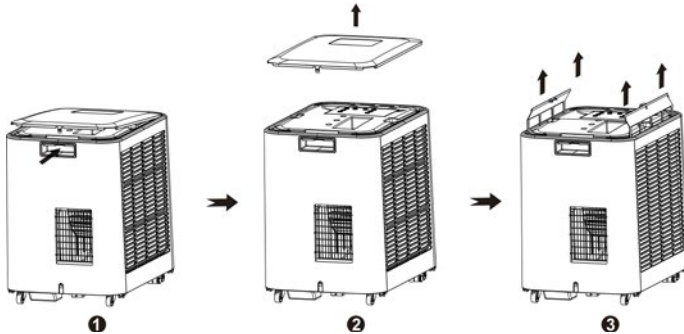

4. Wash the filter in running water, and allow to dry completely before reinstalling.
5. Wipe any dust from the exterior of the unit, with a soft damp cloth.

IMPORTANT: The control panel and other parts must not come into contact with water or any other liquids.

- Do not dispose of electrical appliances as unsorted municipal waste.
- Use separate collection facilities.



- Contact your local government for information regarding the collection systems available.
- If electrical appliances are disposed of in landfills or dumps, hazardous substances can leak into the ground water, polluting the food chain and damaging health and well-being.

OVERHEAT PROTECTION

This unit is fitted with an overheat prevention device. If the unit overheats it will automatically turn off. The unit can be restarted after 30 minutes.

MAINTENANCE

If the unit fails to operate efficiently, is broken or other problems arise, unplug and do not operate. Ask for advice by calling your local after sales service agent or the Customer Care Centre on 1300 556 816 (AU) / 0800 666 2824 (NZ).

MODEL NO.	DC09MINI
Rated Power Cooling	1000W
Cooling Capacity	2600W
Voltage/Frequency	220-240V/50Hz
Dimensions Body (HxWxDmm)	490 x 360 x 480
Refrigerant	R410a
RCM	5336

WARRANTY

The warranty period is 24 months from the date of purchase. For service advice, please contact the Customer Care Centre on 1300 556 816 (AU) / 0800 666 2824 (NZ).

Glen Dimplex Australia Pty Ltd
1340 Ferntree Gully Road,
Scoresby 3179, Victoria
Australia
Ph: 1300 556 816

Glen Dimplex Australasia Ltd
38 Harris Road, East Tamaki,
Auckland 2013
New Zealand
Ph: 0800 666 2824